

# ROTARY UNION

## 1300 SERIES

### FLANGED SWIVEL



#### Operating Parameters

##### MEDIA

Water, Air

##### PRESSURE

290 psi

##### TEMPERATURE

392° F

##### SPEED

Swivel

##### CONNECTION TYPE

2 Inch to 12 Inch Flange

##### MATERIAL

Nickel Plated Steel

\*See Performance Charts for Details

#### FEATURES & BENEFITS

##### Swivel Applications

Used in applications where slow rotation or swiveling motion is needed.

##### GR Seal Technology

Design features include a ball bearing for rotation, and a GR seal for superior sealing performance.

##### Flanged Swivel Design

Allows for stability in high flow applications.

##### High Temperature Applications

Can be used in applications with temperatures up to 392° F.

### Part Numbers - 1300 Series Flanged Swivel

Nominal Pipe Size	Nickel Plated Steel		Stainless Steel	
	Part Number	Description	Part Number	Description
2	760572C	BR50K	790101C	BR50I
2-1/2	760573C	BR66K	790102C	BR66I
3	760574C	BR80K	790103C	BR80I
4	760575C	BR100K	760343C	BR100I
5	760576C	BR125K	790104C	BR125I
6	760577C	BR150K	760344C	BR150I
8	760579C	BR200K	760345C	BR200I
10	760580C	BR250K	780644C	BR250I
12	760581C	BR300K	790105C	BR300I

### Dimensions - 1300 Series Flanged Swivel (in.)

Nominal Pipe Size	No. of Holes	Overall Dia. (A)	B	Slot C	DN	Overall Length (F)	Thread (G)
2	4	6.49	4.92	.70	2	5.90	4 x .70
2-1/2		7.28	5.70		2-1/2		4 x .70
3	7.87	6.29	3		4 x M16		
4	8.66	7.08	4		8 x .70		
5	8	9.84	8.26	.86	5	7.87	8 x .70
6		11.22	9.44		6		8 x .86
8		13.38	11.60		8		12 x .86
10		15.55	13.77		10		
12	17.50	15.70	12				

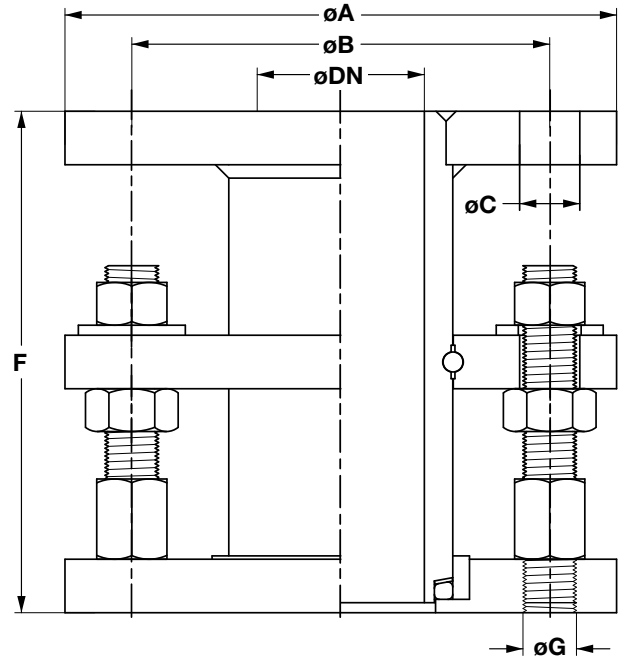

### Performance Charts

